



## Sink S4000

Bowl on the right

Kitchen Sinks

Code: 4386 051



### DETAILS

|                        |   |
|------------------------|---|
| Edge/Installation Type | Flush-mount   Top-mount   |
| Finish                 | Foster brushed  |
| Material               | AISI 304 stainless steel  |
| Texture                | Foster brushed  |
| Base                   | 60 cm   |
| Dimensions             | 873x513 mm  |
| Standard fittings      | Fixing hooks, gasket, drain, overflow and siphon, boxed packing |
| Mixer holes            | 1 standard hole   |
| Built-in hole          | 860x500 mm  |

|         |     |
|---------|-----|
| Drainer | Yes |
|---------|-----|

---

|                |           |
|----------------|-----------|
| Bowl dimension | 450x400mm |
|----------------|-----------|

---

|                 |        |
|-----------------|--------|
| Number of bowls | 1 bowl |
|-----------------|--------|

---

|               |            |
|---------------|------------|
| Waste fitting | 3,5" drain |
|---------------|------------|

---

## FEATURES

|                |   |
|----------------|---|
| High thickness | 1mm thick steel. A significant thickness, which guarantees the maximum sturdiness and durability. |
|----------------|---|

---

|                           |  |
|---------------------------|--|
| Basket 3,5" waste fitting | The drain is equipped with a large 3.5" drain, with the practical basket cap that prevents the discharge of solid parts. |
|---------------------------|--|

---

|                     |   |
|---------------------|---|
| Perimetral overflow | The overflow is always a security on the Foster sinks that prevents the overflow of water in case of oversights. The perimeter drain solution improves aesthetics thanks to its square and essential shape. |
|---------------------|---|

---

|              |  |
|--------------|--|
| Small radius | Bowls with squared shapes with a modern design and an increased capacity, for a minimal aesthetics connected with an extreme practicality. |
|--------------|--|

---

|            |  |
|------------|--|
| Deep bowls | This bowls reach an important depth, over 20 cm, thanks to the advanced production technology, that can be offer great capieny and practicality in all the washing operations. |
|------------|--|

---

## TECHNICAL DATA

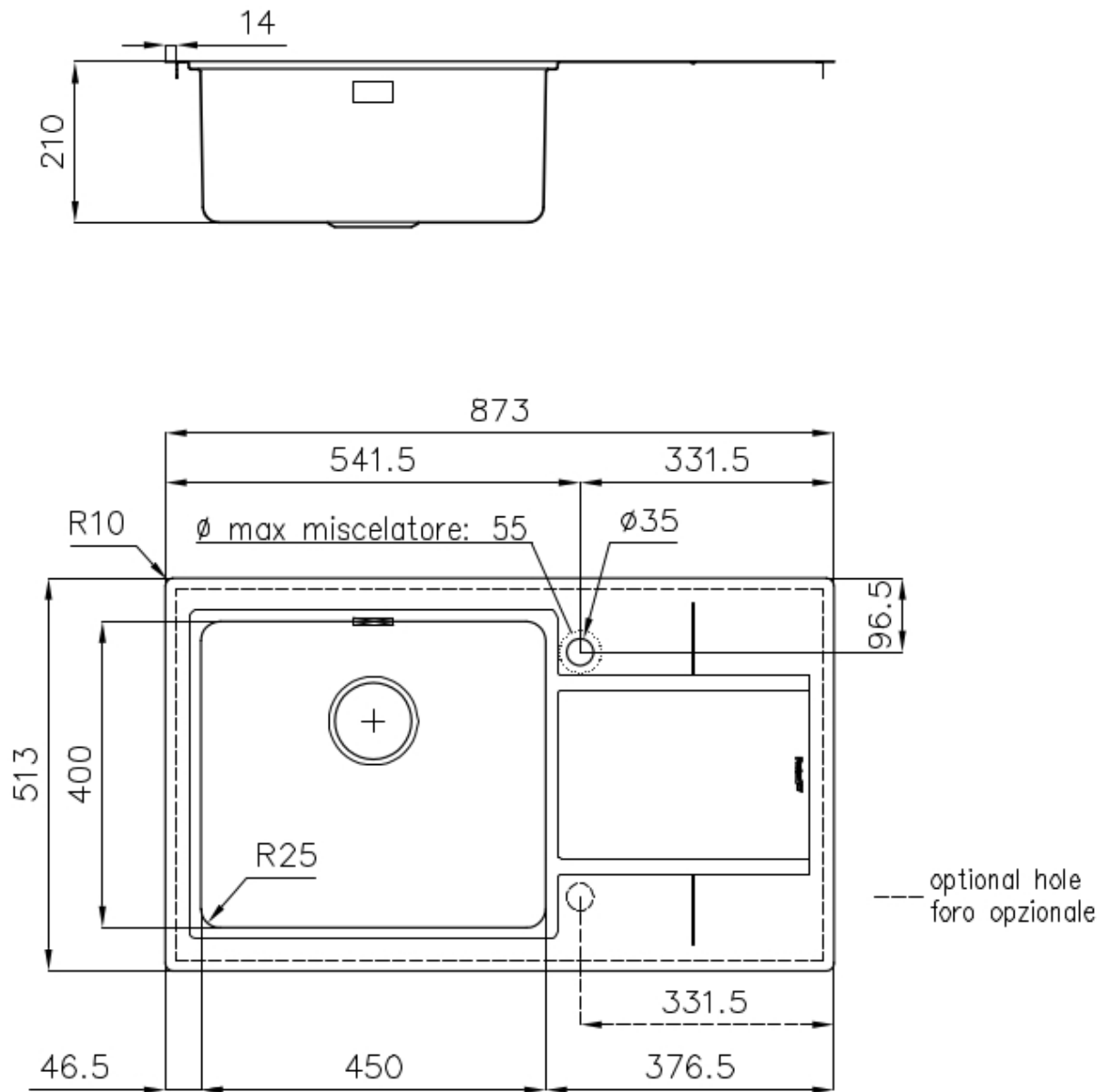

## Lavello S4000 cod. 4386/05\*

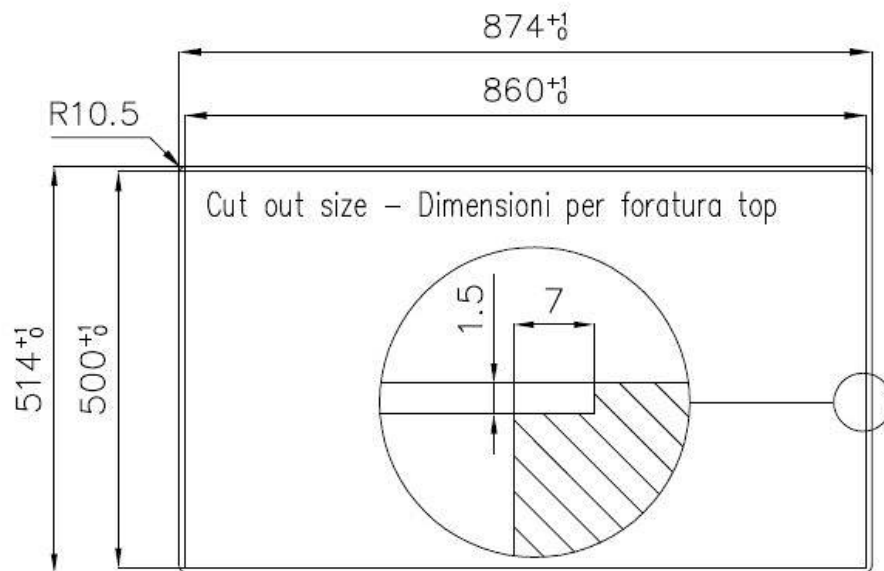

FT

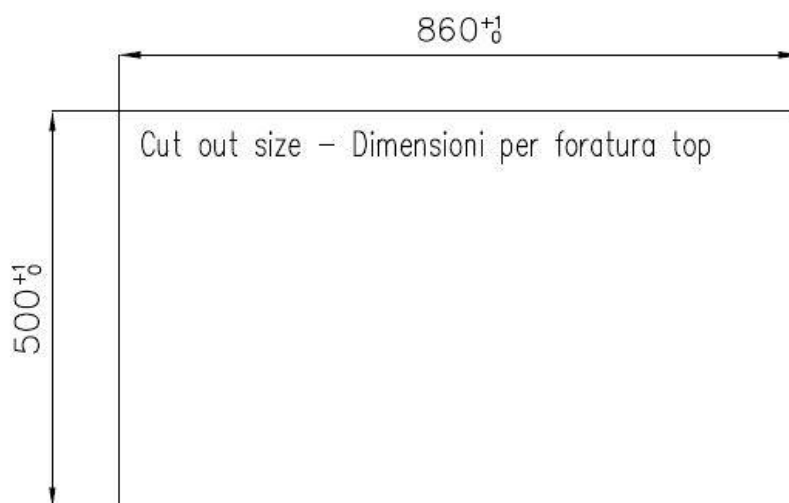

FTS

### GALLERY

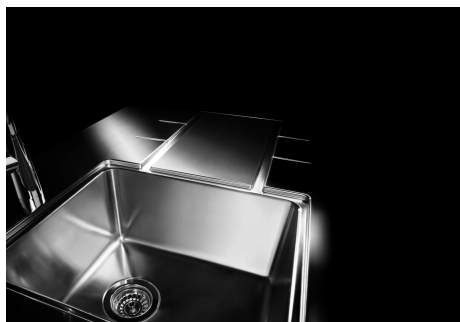

## OPTIONAL ACCESSORIES



**Cestello inox**  
8612 000



**Glass chopping board**  
8631 300



**HPDE Chopping board**  
8657 001



**HPDE Twin chopping board**  
8644 101



**Stainless steel colander**  
8154 000



**Stainless steel plate rack**  
8100 154

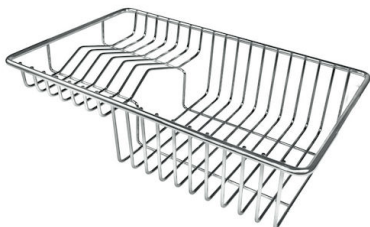

**Stainless steel plate rack**  
8100 303

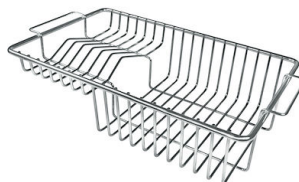

**Stainless steel plate rack**  
8100 201



**White bowl**  
8153 100

\* only in combination with the accessory  
8644 101



**Graters kit with ring-holder and food collection tray**

8159 101

\* only in combination with the accessory  
8644 101



**Stainless steel perforated tray**

8151 000

\* only in combination with the accessory  
8644 101

## RECOMMENDED PAIRINGS



**Mixer Tap Camillo**

8467 000



**Mixer Tap Play**

8487 000